

PROJECT TYPE : ATM CLADDING FOR TID 270 (NCR SELFSEV)

PROJECT LOCATION : DBP BBASILAN BRANCH, J.S. ALANO STREET, SEASIDE BARANGAY, ISABEL CITY, BASILAN

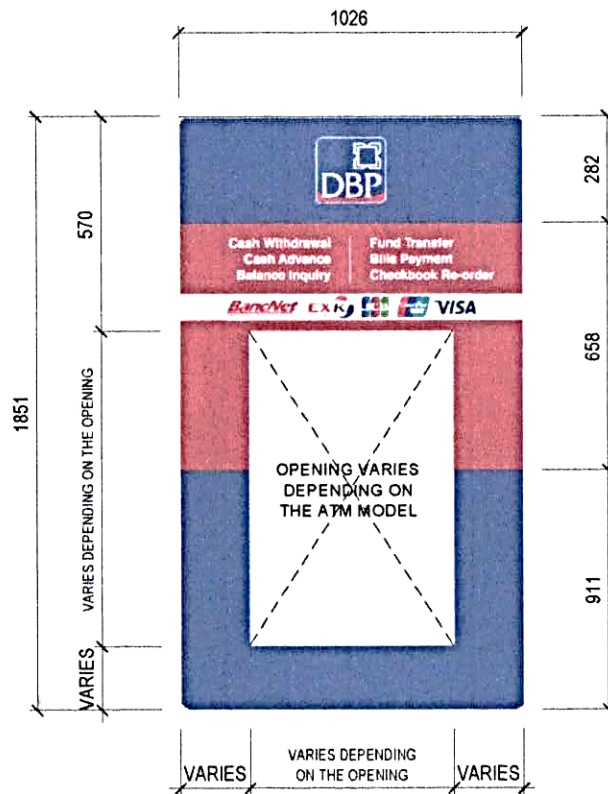

FRONT

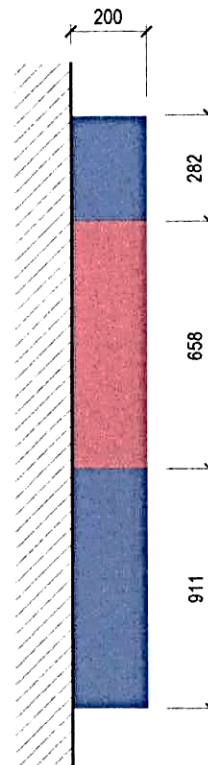

SIDE

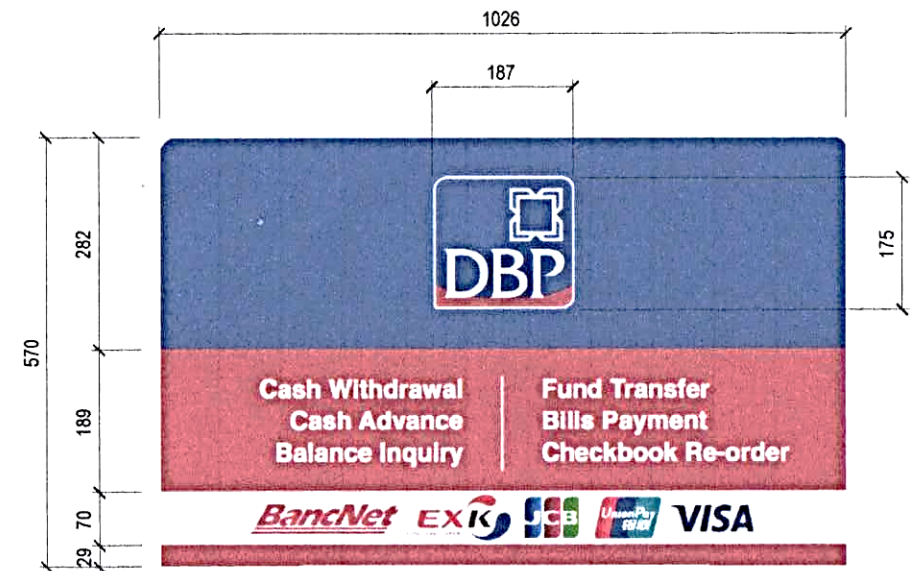

ATM DECALS

ATM CLADDING

TECHNICAL SPECIFICATIONS :

- MADE OF 6MM THK. CLEAR ACRYLIC (FRONT) AND 6MM THK. ACRYLIC FOR SIDINGS AND BACKING
- TRANSLUCENT STICKER (FOR ATM CLADDING AND DECALS)
- COMPUTER CUT-OUT WITH LAMINATION FOR DECALS AND LOGOS
- COMPLETE WITH LED LIGHTING SYSTEM (PLEASE PROVIDE ELECTRICAL PLUG, WIRING CABLE AND SWITCH OR TAP ON THE CENTRALIZED TIMER, WHICH EVER IS APPLICABLE); WHOLE CLADDING MUST BE FULLY LIGHTED.

PANTONE COLOR:

- FOR BACKGROUND - 3630-157 SULTAN BLUE AND 3630-73 DARK RED
- FOR CARD NETWORK - COLORS AS PRESCRIBED BY THE CARD NETWORK

FONT:

- FOR DBP - FRIZ QUADRATA

NOTE:

- VERIFY ACTUAL MEASUREMENT OF UNIT

SIGNED