



DEVELOPMENT BANK OF THE PHILIPPINES
Head Office: Sen. Gil J. Puyat Avenue corner
Makati Avenue, Makati City, Philippines

**REQUEST FOR QUOTATION
FOR
SUPPLY AND DELIVERY OF VARIOUS OFFICE CHAIRS AND FILING CABINETS FOR BBG
CEV WARD BRANCHES**

1. The *DEVELOPMENT BANK OF THE PHILIPPINES BRANCH BANKING GROUP-CENTRAL & EASTERN VISAYAS* (DBP BBG-CEV) through the *CORPORATE BUDGET OF DBP FOR CY 2025* intends to apply the sum of **One Million Eight Hundred Fifty-One Thousand Six Hundred Pesos Only (Php 1,851,600.00)**

Clerical Chair/s:

Bogo Branch	9 pcs	P 278,720.00
Carcar Branch	7 pcs	
Mandaue Branch	7 pcs	
Tagbilaran Branch	6 pcs	
Talisay Branch	9 pcs	
Ubay Branch	8 pcs	

Gang Chair/s:

Maasin Branch	1 pc	P 140,000.00
Catbalogan Branch	6 pcs	

Client or Visitor's Chair/s:

Bogo Branch	17 pcs	P 188,800.00
Carcar Branch	2 pcs	
Mandaue Branch	10 pcs	
Ormoc Branch	12 pcs	
Tagbilaran Branch	6 pcs	
Talisay Branch	6 pcs	
Toledo Branch	9 pcs	

High Back Chair/s:

Bogo Branch	1 pc	P 18,080.00
Tagbilaran Branch	1 pc	

Mid-Back Chair/s:

Talisay Branch	1 pc	P 49,500.00
Carcar Branch	1 pc	
Tagbilaran Branch	1 pc	
Tacloban Branch	1 pc	
Catbalogan Branch	1 pc	
Cebu Branch	2 pcs	
Mandaue Branch	1 pc	
Tubigon Branch	1 pc	



DEVELOPMENT BANK OF THE PHILIPPINES
Head Office: Sen. Gil J. Puyat Avenue corner
Makati Avenue, Makati City, Philippines

Teller's Chair/s:

Mandaue Branch	3 pcs	P 58,500.00
Maasin Branch	1 pc	
Tagbilaran Branch	4 pcs	

4-drawer Lateral Steel Filing Cabinet

Dolores Branch	3 pcs	P 60,000.00
Mandaue Branch	1 pc	

4-drawer Vertical Steel Filing Cabinet

Maasin Branch	1 pc	P 15,000.00
---------------	------	-------------

Signature Card Rack/Cabinet

Borongan Branch	1 pc	P 1,030,000.00
Carcar Branch	1 pc	
Catbalogan Branch	2 pcs	
Dolores Branch	1 pc	
Maasin Branch	1 pc	
Tacloban Branch	1 pc	
Tagbilaran Branch	1 pc	

Side Table

Bogo Branch	2 pcs	P 13,000.00
-------------	-------	-------------

Grand Total: P 1,851,600.00

Note:

- Conditions stated in the technical specification shall be applied to the item listed above
- Proposal shall include the delivery charges and all applicable taxes/charges
- Payment: No downpayment. Processing of payment via check shall only proceed upon complete delivery.

The deadline for the submission of price quotations shall be on or before Aug. 20, 2025, at DBP Cebu Bldg. Osmena Boulevard, Cebu City, Cebu. Please contact **Azenith Jaymil A. Lumabi** at telephone numbers **(032) 255-6325**. You may also email your proposal/quotation at **cevb@dbp.ph**

Only price quotations from Filipino citizens or companies duly registered with the Department of Trade and Industry or Securities and Exchange Commission, with current business permits and those that are PHILGEPS registered shall be accepted.

Development Bank of the Philippines, BBG-Central and Eastern Visayas, reserves the right to reject any and all bids/price quotations, to waive any defect in them and to award to the bidder/participant whose bid/price quotation is the most advantageous to the Bank.

-signed-
SM CHRIST E. VALDEHUEZA
Chairman, RBAC CV



DEVELOPMENT BANK OF THE PHILIPPINES

Head Office: Sen. Gil J. Puyat Avenue corner
Makati Avenue, Makati City, Philippines

GANG CHAIR

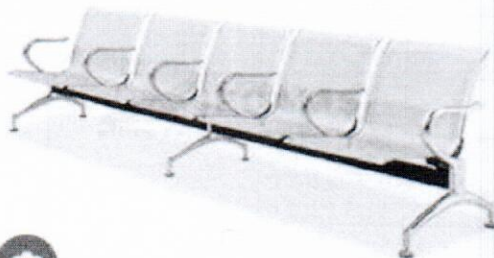

SS-A19

Gang Chair - 5 Seater

Materials: Arm and leg frames are steel with chrome plated finish. Beam section is top quality steel, powder coated. 150kg weight rating per seat. Perforated Seat and Back.

Dimension :
W287xD63.5xH81.28cm

Finish: Silver, Red, Blue, Black
Warranty : 1 year



Office Furniture / Chairs / Office and Clerical Chairs

JG208H20G Teller Chair

★★★★☆

1 review

Tellers chair with adjustable gaslift in foot rings, with PU base and 3 castor wheels and 2 gliders.

- Color: PVC Black, Black or Gray
- 2 years warranty on parts
- Made in Taiwan
- Height: 39.5" - 44.5"
- Seat Depth: 15.5"
- Footrest: D19"
- Starbase: D23"



(02) 8-818-9511



info@dbp.ph



www.dbp.ph



fb.com/devbankphl

Technical Specifications



High Back Chair

Headrest - 0.9mm black nylon mesh circular pattern hole in curved/molded polypropylene frame and adjustable height.

Measurement – 279.4mm width x 152.4mm height

Backrest - 0.9mm black nylon mesh circular pattern hole in curved/molded polypropylene frame and adjustable height. Tension knob for comfort adjustment.

Measurement – 469.9mm width x 635mm height

Lumbar Support: 0.9mm black nylon mesh circular pattern hole in curved/molded polypropylene frame and adjustable height.

Measurement – 254mm width x 101.6mm height x 38.1mm foam thickness

Seatrest-0.6mm black polyester fabric in curved/molded injected foam and wood support. Adjustable seat height

Measurement: 508mm width x 508mm height with 71.12mm foam thickness

Armrest: Black-silver nylon padded curved/molded in polypropylene frame and adjustable height.

Measurement – 101.6mm width x 254mm height with 25.4mm pads thickness

Base: Aluminum star base (chrome finish) with polypropylene twin wheel caster.

Measurement – 685.8mm width End to End

Weight Capacity: min. of 112 kgs

Size Tolerance ± 25.4 mm in either direction

Note: Design should be the same or similar as the above photo

W g

Technical Specifications



Midback Chair

Fabric moulded foam-cushion upholstered seat and backrest; gas lift; with arm rest; five (5) legged nylon star base with twin caster; tilting/swivel mechanism

Color: Twilight Blue

Dimensions:

- Seat: minimum of 500 mm x 470 mm
- Backrest: minimum of 550 mm x 500 mm
- Height: minimum of 901 mm (adjustable)
- Size Tolerance ± 25.4 mm in either direction

Weight Capacity: min. of 112 kgs

Note: Design should be the same or similar as the above photo

W g pth

Technical Specifications



Clerical Chair

Fabric moulded foam-cushion upholstered seat and backrest; gas lift; with arm rest; five (5) legged nylon star base with twin caster; tilting/swivel mechanism.
Color: Twilight Blue

Dimensions:

- Seat: minimum of 500mm x 450mm
- Backrest: minimum of 450mm x 500mm
- Height: minimum of 800mm (adjustable)
- Size Tolerance ± 25.4 mm in either direction

Weight Capacity: min. of 112 kgs

Note: Design should be the same or similar as the above photo

by [signature]

Technical Specifications

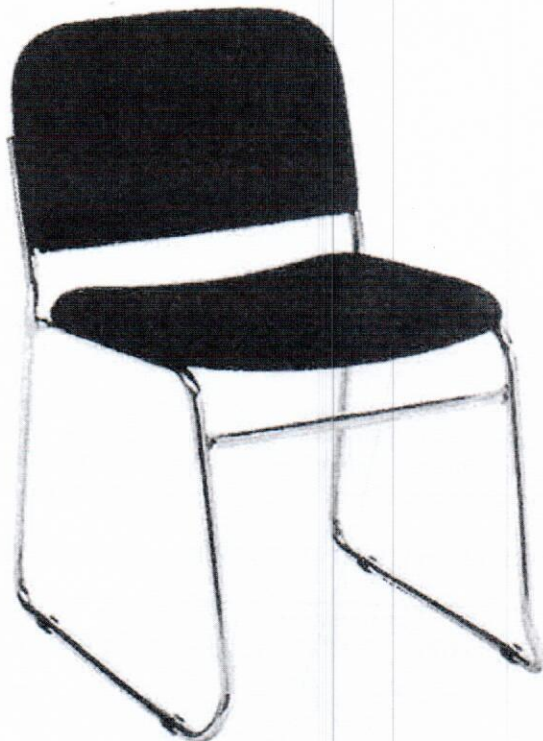

Visitor's Chair

Fabric moulded foam-cushion upholstered seat and backrest; **without armrest**; gauge 18 steel with 5/8" round-tubular construction chrome finish (sled type leg) and poly floor glides

Color: Twilight Blue

Dimensions: minimum of 584 mm (W) x 584 mm (DD) x 762 mm (H)

-Seat: minimum of 420mm x 420mm

-Foam Thickness: 1.5 inches

-Size Tolerance ± 25.4 mm in either direction

Weight Capacity: min. of 112 kgs

Note: Design should be the same or similar as the above photo

69

Technical Specifications

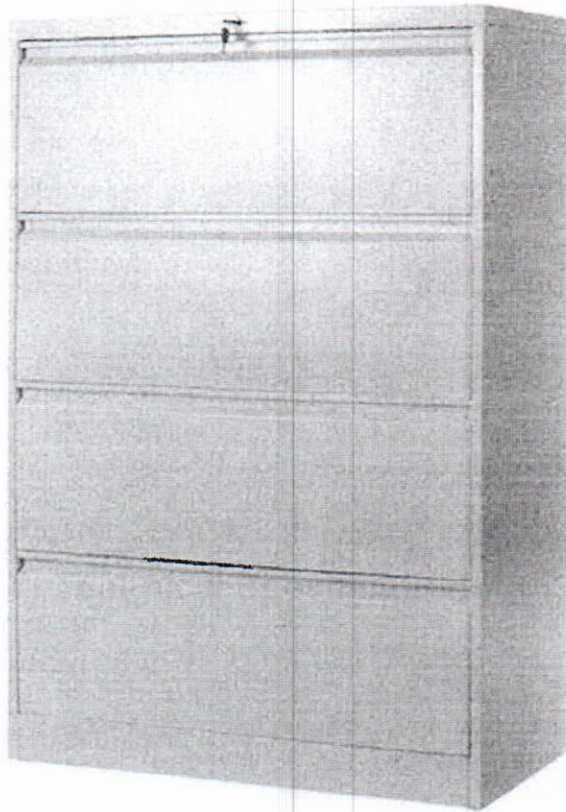

4-Drawer Lateral Filing Cabinet

Materials: cold-rolled steel plate gauge #20

Finish: Powder coated as anti-rust protection

Features: Recessed handle, centralized locking system with black plastic divider per drawer

Color: Light Gray

Dimensions: 900 mm (W) x 450 mm (D) x 1320 mm (H);

Size tolerance (± 25.4 mm in either direction)

Note: Design should be the same or similar as the attached photo in Exhibit 6

Technical Specifications



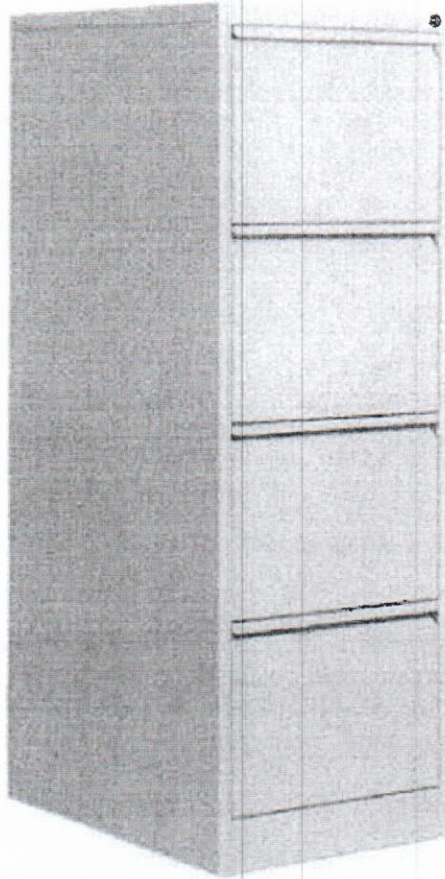

4-Drawer Vertical Filing Cabinet

Materials: cold-rolled steel plate gauge #20

Finish: Powder coated as anti-rust protection

Features: Recessed handle, centralized locking system with black plastic divider per drawer

Color: Light Gray

Dimensions: 460 mm (W) x 620 mm (D) x 1325 mm (H);

Size tolerance (± 25.4 mm in either direction)

Note: Design should be the same or similar as the attached photo in Exhibit 7

Technical Specifications

Wg

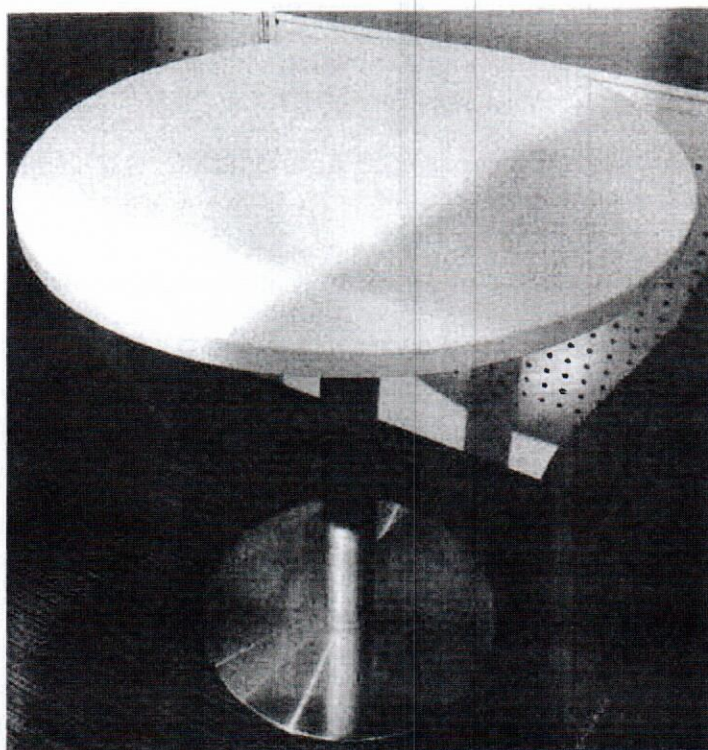

Round Table

30mm thk. MDF countertop in high pressure laminate (HPL) finish with PVC edging and steel frame leg (hairline finish).

Color: **Light Gray**

Size : 0.90 m to 1.20 m diameter

Handwritten signature

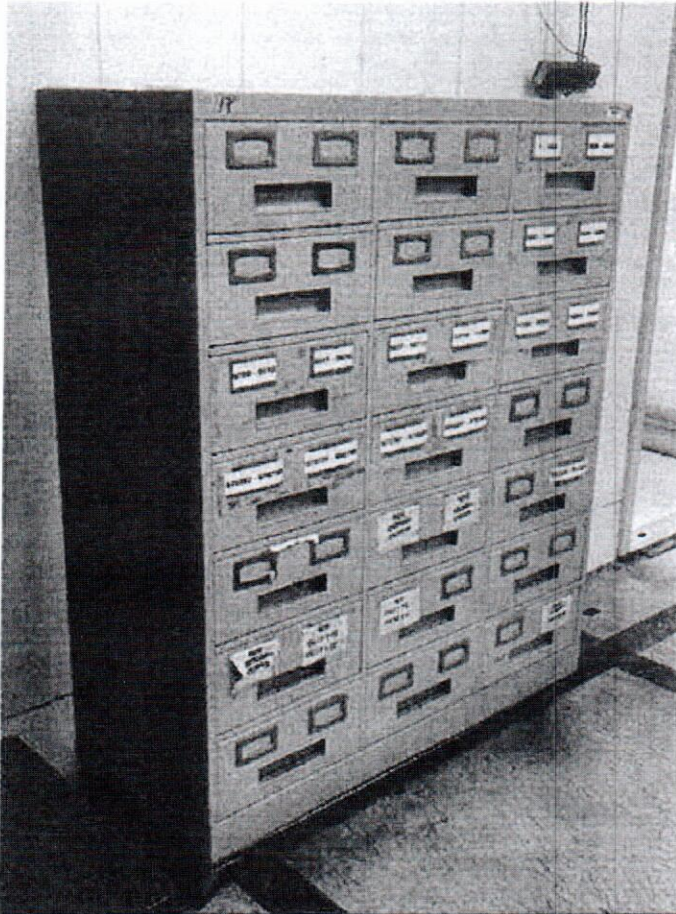

Signature
Card Rack/
Cabinet

- Signature card rack/cabinet (21-drawers);
- Dimension: 1,041mm (L) x 457mm (W) x 1,359mm (H); Size tolerance: (± 25.4 mm in either direction)
- steel gauge 20;
- steel component in powder coated finish; with central locking mechanism; with heavy duty wheel caster;
- color: light gray
- (Size of Signature Card: 5 ½" x 5")

Note: Design should be the same or similar as the photo in

Cor
9

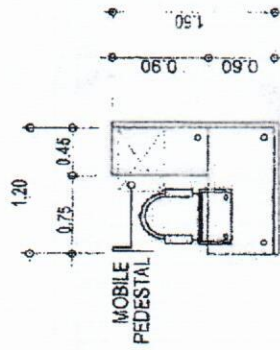

PLAN
OPTION 2

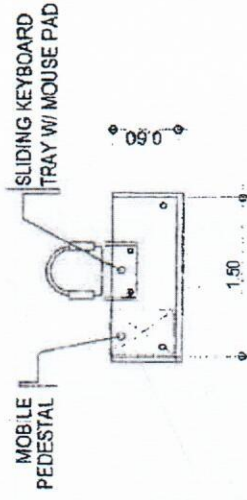

PLAN
OPTION 3

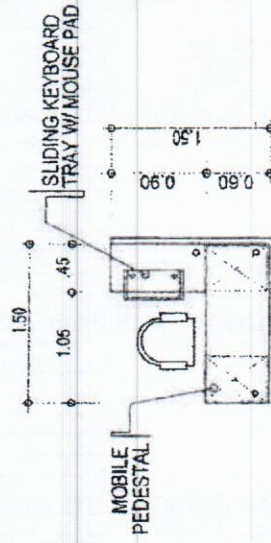

PLAN
OPTION 1

RANK & FILE WORKSTATION
AREA COVERAGE: 2.25 SQ. M.

W
g